



CHANTELLA

Motor yacht Chantella, built in 1966 by Chantier Naval d'Antibes and designed by Henri Rambaud, is a timeless classic offering elegance and comfort. At 30m in length, she accommodates 8 guests in 4 luxurious cabins and up to 4 crew members. Powered by twin Detroit Diesel engines, she cruises at 15 knots and reaches a top speed of 18 knots, with a range ideal for extended Mediterranean voyages.

Constructed with a mahogany hull, she blends classic charm with modern updates, including major refits in 2019 and 2023. She features Wi-Fi, air conditioning, and a variety of water toys, making her perfect for both relaxation and adventure. Chantella is a true gem for discerning yachting enthusiasts.

SPECIFICATIONS

Built	1966/2019
Builder	Chantier Naval D'Antibes
Beam	5.80 M / 19'08"
Draft	2.80 M / 9'02"
Hull Material	Wood
Gross Tonnage	110
Engines	2 X VOLVO PENTA D13 515 KW
Speed	15 cruise / 19 max
VAT	N/A
Price	1.499.000 €



Constantin Capsis
M: +33 6 26 07 58 76
T: +377 92 000 999
constantin@stars.mc

START CHAT



Jonathan Cecotto
M: +33 6 07 93 53 36
T: +377 92 000 999
jonathan@stars.mc

START CHAT



Yachts offered are subject to availability. The particulars are believed to be correct but are not guaranteed and may not be used for contractual purposes. Specification provided for information only.





Yachts offered are subject to availability. The particulars are believed to be correct but are not guaranteed and may not be used for contractual purposes. Specification provided for information only.





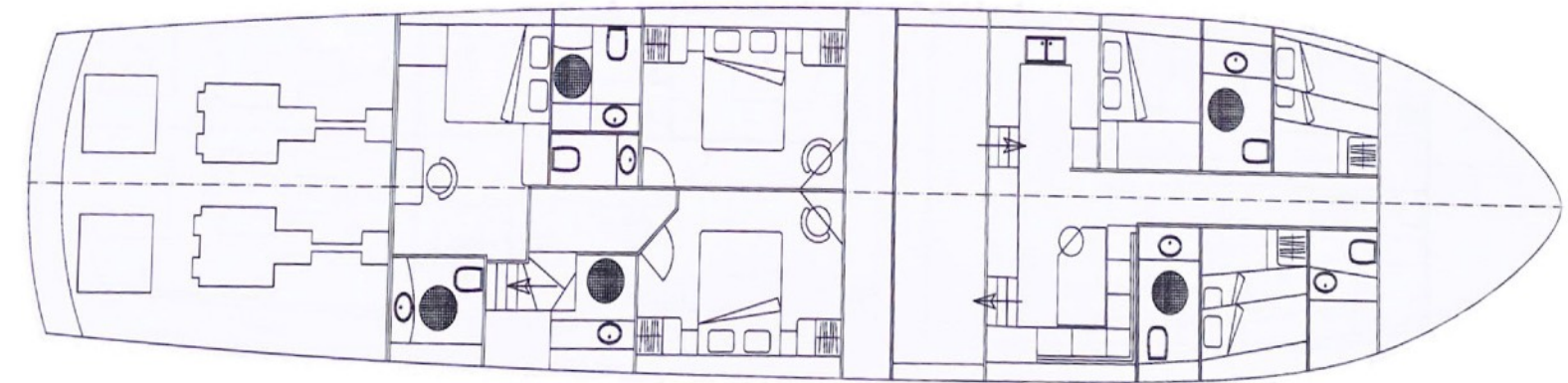
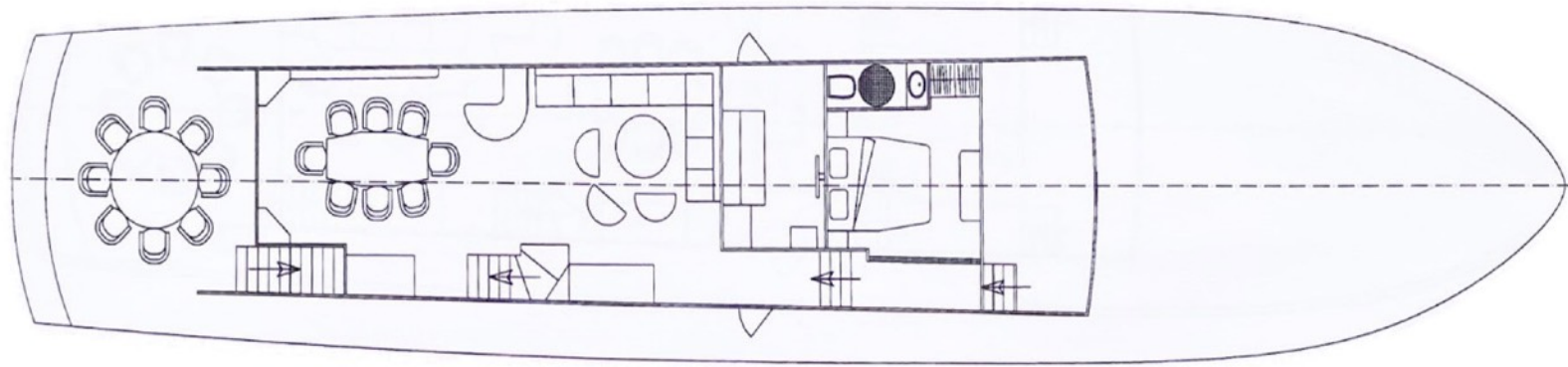

Complete Refit in 2019: Chantella underwent a comprehensive refit, modernizing her facilities while preserving the classic elegance that defines her character.

Sun deck extended upto 5m

Brand New Engine Room: Post-refit, Chantella boasts a fully updated engine room, ensuring reliable performance and state-of-the-art operations.

Highly Sought-After Charter Yacht: With a reputation as a top-tier charter yacht, Chantella offers an exceptional experience, blending classic design with modern luxury

2024

Sun deck extended by 5m

Antifouling, chains of anodes

Besenzoni passerelle maintenance

Engine and generator maintenance (oil change)

Port-side chain replaced

Hull paint job

Re-varnishing capling rails

New steering pump

2023

Engine and generator maintenance

Antifouling chain of anodes

2 x Steering rudder maintenance

New wood underneath starboard generator

Gearbox maintenance

2019

Additional guest cabin installation

Main Characteristics

Name:	CHANTELLA
Type:	Motor Yacht
Builder:	Chantiers Naval d'Antibes
Year:	1966
Refit Year:	2019
LOA (M/FT):	30.00
Beam (M/FT):	5.80
Draft (M/FT):	2.80
Gross Tonnage:	110
Hull Material:	Wood
Decks:	Teak
Flag:	British
Classification:	MCA
Exterior Designer:	H. Rambaud
Interior Designer:	Blanc Bleu
Main Engines:	2 x Volvo Penta D13 515 kW
Max Speed:	19 kts Max
Cruising Speed:	15 kts Cruising
Guest Accommodation:	8 guests in 4 staterooms
Crew Accommodation:	4 crew in 3 cabins (with capacity for 1 additional crew)

Capacities

Gross Tonnage:	110
Net Tonnage:	110
Fuel Capacity:	7,000
Fresh Water Capacity:	3,000
Grey Water:	450
Black Water:	450

Main Machinery

Main Engines:	2 x Volvo Penta D13 515 kW
Engine Hours (April 2024):	Port: 750 hrs Starboard: 750 hrs
Gear Boxes:	ZF Marine 20004420

Generators and Electricity

Generators:	2 x Cummins Onan
Generator Hours (April 2024):	Port: 6,612.1 hrs Starboard: 8,146.2 hrs
Shore Power:	Coelmo Electric 380 V
Battery Chargers:	Tecpro

Auxiliary Machinery

Steering System:	Simrad AP35
Emergency Steering:	Yes
Bow Thruster:	Lewmar
Stabilisers:	CMC Electra Eco FX
Under Water Lights:	x 2

Fuel & Oil System

Fuel Filters:	Racor F11-1413
---------------	----------------

Water System

Fresh Water Makers:	Tecnicomar 120 ltr per/hour
Black & Grey Water Treatment:	Yes

AC & Ventilation System

Air Conditioning:	Frigomar
Air Compressor:	Mecafer
Engine Room Ventilation:	Yes

Navigation & Communication

Monitors:	Furuno
Chart Plotter:	Sea Map
Magnetic Compass:	Yes
Gyrocompass:	Simrad
Echo Sounder:	Furuno
Depth Sounder:	Raymarine
DGPS:	Furuno
VHF:	Furuno
Radios:	4 x Icom

Deck Machinery & Equipment

Anchors:	2 x New (Brand name)
Anchor Chains:	New anchor chains (Port : 100m & Starboard: 75m)
Cranes:	2 x SC (Jet ski crane capacity 600 kg & Tender crane capacity 800 kg)
Passerelle:	Besenzoni (new)
Swimming Ladder:	Yes
Spotlights:	x 1
Paint Exterior:	Awlgrip

Safety, Security & Fire Fighting Equipment

Fixed Firefighting System:	FM 200
Smoke Detection:	Yes + Carbon monoxide detector in each cabin + engine room)
Life Rafts:	24 pax
Lifejackets:	x 16
Immersion Suits:	x 1
Life Rings:	x 2
EPIRB:	Yes
Flares and Signals:	2 x Smoke flares, 6 x Hand flares & 4 x Parachute flares
Medical Equipment:	Yes

Entertainment, Audio, Visual & IT

Video Equipment:	Samsung Smart Tv
Audio Equipment:	Sonos Sound System
Main Salon:	1 x Samsung Smart Tv 43 inch
Master Stateroom:	1 x Samsung Smart Tv 32 inch
WIFI:	Yes

Galley & Laundry Equipment

Cooking Equipment:	Hot plates
Refrigeration/Freezer:	2 x Whirlpool
Dishwasher:	1 x Electrolux
Other:	1 x Whirlpool Microwave 1 x U-Line Ice maker (Main Salon)
Sun Deck:	1 x Isotherm Fridge 1 x Barbecue
Wine Cellar:	1 x Main Salon
Main Laundry Equipment:	1 x Whirlpool
Dryer:	1 x Candy

Tender & Toys

Tenders:	BSC RIB 4.5m 80 HP 1 x Suzuki 150 HP 5.7m Dinghy
Jet Skis:	Yamaha VX110 4 strokes (2020)
Toys:	1 x iAqua Seabob 1 x Paddleboard 1 x Wakeboard Inflatable donut Snorkels and fins (range of sizes)

Gyrocompass:	x 1
Echo Sounder:	Awlgrip

Safety, Security & Fire Fighting Equipment

Fixed Firefighting System:	FM 200
Smoke Detection:	Yes + Carbon monoxide detector in each cabin + engine room)
Life Rafts:	24 pax
Lifejackets:	x 16
Immersion Suits:	x 1
Life Rings:	x 2
EPIRB:	Yes
Flares and Signals:	2 x Smoke flares, 6 x Hand flares & 4 x Parachute flares
Medical Equipment:	Yes

